

# Beneteau Oceanis 58 *New*



**New 2010**

Document no contractually binding

**Architect :** Berret Racoupeau Design

**Architecture and internal design:** Nauta Design

Enter a new dimension and take the time to experience the sea infinitely: the Oceanis 58 is an exceptional sailing boat where all is light, luxury and harmony. It is inspired by yachts without losing its bearings.

### Key features

- Hull designed to perform with a moderate heel
- Original, pragmatic management of the tender:
  - Storage on the stern deck with 3 lifting solutions
    - Standard: Lifting by an integral system with rollers
    - Option: Hydraulic bridge crane
    - Option: Instrument support arch and davit function
- Translucence and special treatment of light:
  - Extra-wide companionway canopy
  - Elongated Plexiglas portholes in the saloon
  - Panoramic portholes in the aft cabins
- Companionway:
  - Retracting, motorised entrance door (optional) in the cockpit well
  - Gently sloping stairway with handrails / banisters
- Numerous motorised or assisted solutions (standard or optional):
  - Electric entrance door and side blinds,
  - Universal recharging dock (telephone, MP3, games console),
  - TV on hoist,
  - Cockpit lockers assisted by gas struts,
  - Damped hinges for drawers
- Luxury and looks:
  - Top quality faucets and door handles,
  - LED lights and stainless steel and leather reading lights
  - New Alpi mahogany stain- brighter & lustrous
  - Extra wide (+13 %) cabin doors
- Real ocean-going solutions:
  - High capacity water and fuel tanks
  - Multi-solution rigging
  - Equipment-carrying arch/davit (solar panels, wind generators)

# Beneteau Oceanis 58 *New*

## Hull - Rigging

### ① Rigging – Sails

- Sails made by Incidences
- Standard:
  - Traditional Selden mast, 3 levels of spreaders, anodised aluminium
  - Full batten mainsail and Dacron double seamed Genoa
- Options:
  - Anodised aluminium Selden auto-furling mast, Triradial cut Mylard Taffetas mainsail
  - Mylard Taffetas: Top performance, output and look improved by long-lasting sail geometry (Mylard Taffetas > Dacron module)
  - Hydranet sails for traditional mast: Triradial cut Hydranet mainsail and Genoa set. Hydranet: high quality fabric that ages well (UV and moisture), less distortion due to the inclusion of a warp made from Spectra
  - Hydranet moveable staysail on furler staysail and self-tacking gear
  - Stormlight Code 5 (fairly flat gennaker)
  - Asymmetric spinnaker

Document no contractually binding

### ② Bow thruster (Easy Docking pack) 24V – 16 hp: essential equipment!

### ③ Two drafts:

- 8' 6"/2.60 m/ (standard)
- 6' 11"/2.10 m (optional)



# Oceanis 58 *New*

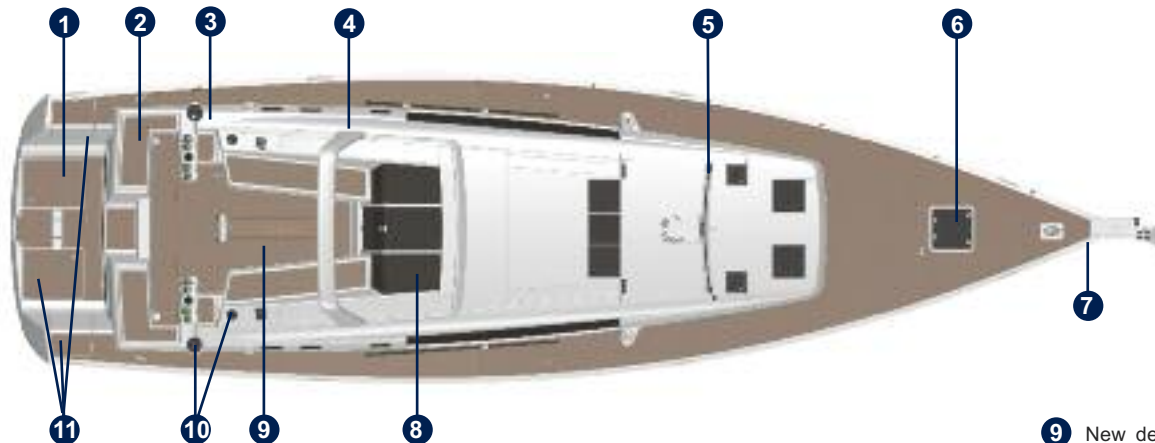

## Cockpit / Deck

- 1** Stern deck: A sea-level platform (about 8' 8" x 4' 5") including a tender lifting system with rollers as standard. Optional hydraulic bridge crane or instrument carrying arch-davits
- 2** Wheelhouses and docking stations at the aft of the cockpit  
Helmsman's seats with PVC Silver backrest on pushpits,  
Easy-to-use wheelhouse with stuff compartment (optional) glass holders, instrument supports (instruments optional)
- 3** Access stairs to catwalks with integral cubby holes

- 4** Fixed arch:  
Fixing point for the mainsail boom (easier to adjust and more effective)  
2 Stainless steel handrail for safety when leaving the cockpit  
Integral cockpit light and loudspeakers  
Fully integrated optional dodger between the arch and the moulded housing on the deck.
- 5** Roller-furling gear for the staysail: included in the "Jettisonable staysail stay" or "Staysail furler" options.

- 6** Access to the sail locker (standard) or bow cabin (optional) by large deck hatch (size 70)

- 7** Flush bow
  - Chain locker inspection and maintenance hatch accessible via the sail locker / bow cabin.
  - Vertical shaft electric anchor winch on deck (2,000 w)
  - Open pulpit with tread-plate

- 8** PMMA companionway hatch fully integrated into the canopy:
  - Electric locking
  - Companionway hatch that stows under the deck, Foldaway entrance hatch in the cockpit well.
  - Optional: remote control powered opening and closing

- 9** New design, solid wood cockpit table with two leaves.  
The plotter is at the end of the table on a tilting, 360° pivoting "ball" support: to follow the course from the wheels or watch a film in the cockpit.

- 10** Sailing controls relayed aft: manoeuvre and Genoa securing systems and winches

- 11** Dedicated, integral stowage:
  - Port: Gas locker can house all types of cylinder(s) (examples: two cylinders nested or one larger cylinder)
  - Starboard: Life raft locker with direct sea access
  - 2 wet lockers in the cockpit well

# Beneteau Oceanis 58 *New*

## Saloon



- 1** Practical, carefully designed galley which makes optimal use of space:
- Depth and height of units
  - 2 rectangular sinks with strainer
  - Bin with rubbish emptying access
  - Draw units with dampers

- 2** Luxury gas oven on gimbals, 3 burners, with grill, as standard
- Réchaud electric oven optional
  - Exhaust fan with Avantage finish

- 3** Relaxation area:
- Sofa with full depth seat and arm rest.
  - Leatherwork especially well finished
  - Bar and ice maker storage space (optional)

- 4** Space for 32" TV with lift system (optional)

- 5** Welcoming saloon with folding, pivoting wooden table and foldaway seat in the axis of the boat

- 6** Big office chart table with comfortable seats (back and armrest)
- Mobile and office functions featured:
- Universal recharging station (optional)
  - Numerous 110v sockets
  - Space for 12" plotter
  - PC interface lead (optional) for connecting a laptop, etc.

- 7** Wet locker that can be fitted with a 1 drawer fridge (capacity 105l) for storing food or drinks (optional)
- Lower unit: Big storage cupboard

# Beneteau Oceanis 58 *New*

## 3 Cabins – 3 Toilets + Bow cabin (optional)

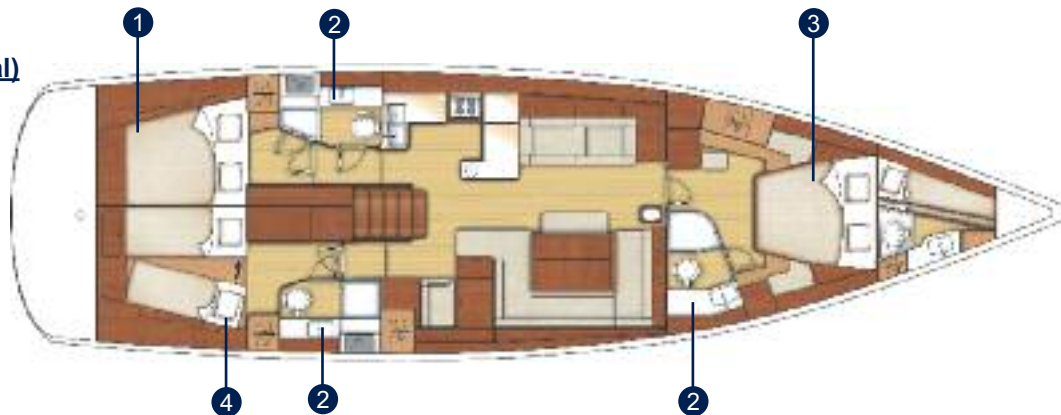

- 1** Guest cabin with large double bed (6' 9" x 4' 7" x 5' m). Marine mattress on a base with slats for comfort.
- 2** Each cabin has its own private bathroom with separate shower (tray and shower screen).  
2 standard holding tanks (2x21 gals) in aft heads.  
Aft port toilet can be used as everyday toilet

- 3** Master's cabin with large (6' 9" x 5' 7" x 4') island bed (marine mattress – base with slats for comfort)  
Dressing-table with mirror, storage and adjoining shelves, leather tidy (optional) and mobile seat with fixing point when sailing

Large amounts of storage space intelligently arranged:

- Dressing and locker with courtesy light
- Unit for shoes
- Drawers under the bed
- Chests under the bed easily accessible by means of the gas strut fitted unit, space for a safe (optional)
- Bedside tables,
- Closed lockers
- and much more...

- 4** VIP cabin  
The most spacious of the aft cabins  
2 single beds (6' 7" x 2' 10" + 6' 7" x 2' 7") that can be put together as a double (marine mattresses and standard bases with slats for comfort)  
Dressing table with leather tidy (option)

# Oceanis 58 *New*

**4 Cabins – 4 Toilets**  
**+ Bow cabin (optional)**



Document no contractually binding

- 1** 2 symmetrical forward cabins  
 Easy access because of the space forward of the mast, the extra-wide doors and flush floor  
 Beds 6' 9"x4' 11" (marine mattresses and standard bases with slats for comfort)

- 2** Bow cabin (optional):  
 2 bunk beds (lower bed 6' 5"x 2'2" – Upper bed 6' 5" x 2'2") with PVC cover  
 Upper bed folds away along the wall for more space and access to the chain locker  
 Shower tray in the companionway with semi-rigid transparent shower screen